

Getting Started Guide

[Click here for a video guide to getting started](https://youtu.be/9sExDnpyUAM)

<https://youtu.be/9sExDnpyUAM>

01

Download and
open the Math
Shelf App

02

Click "sign in"

03

Sign in with your
school email and
password (your
first name)

04

Enter your teacher
info and touch
"submit"

Adding Students

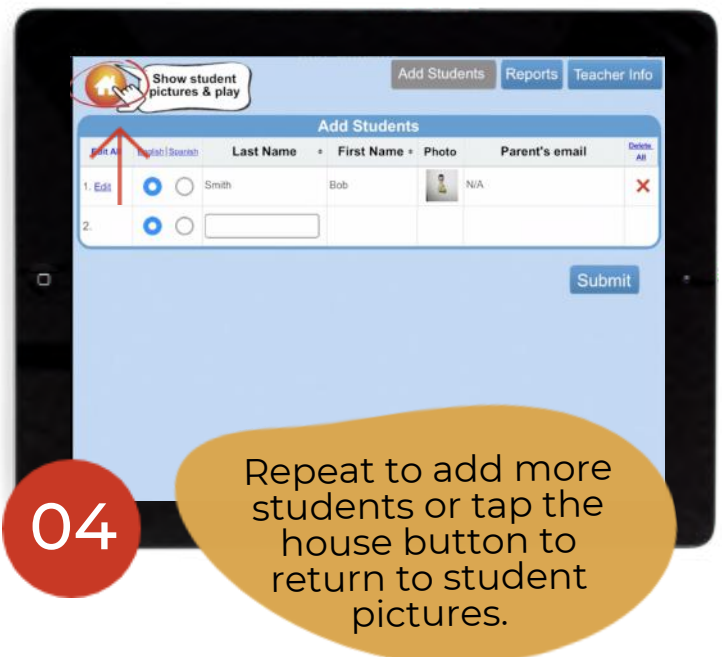
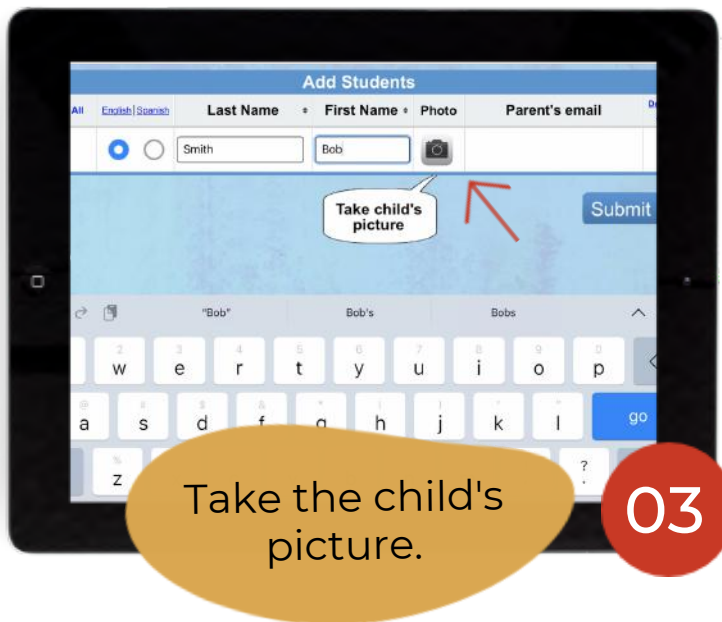
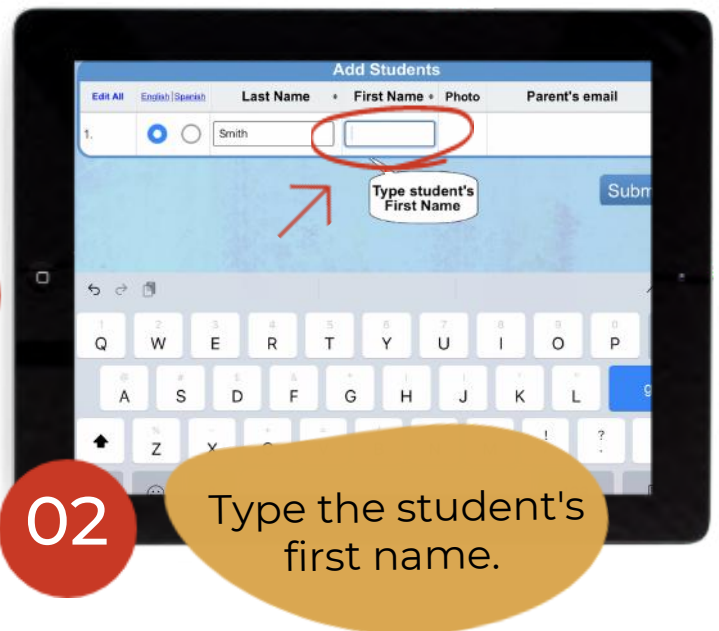
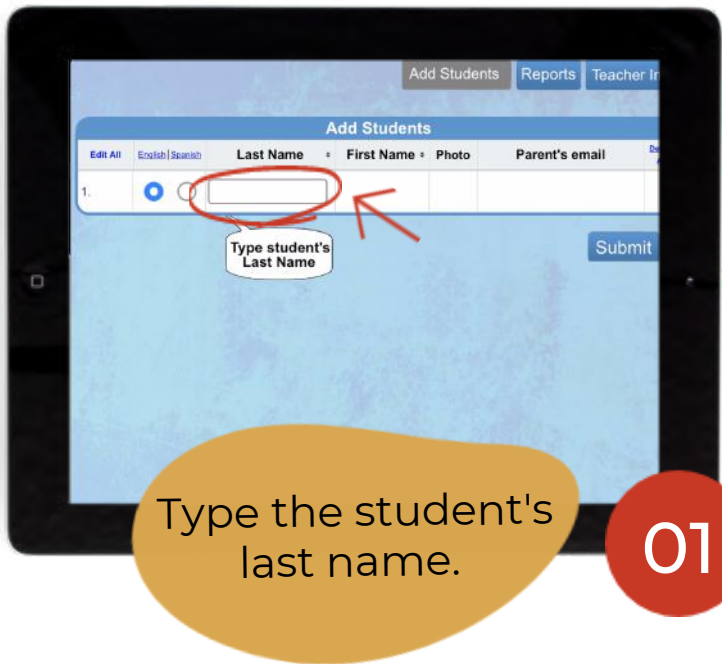



Create Math Shelf Center

<https://youtu.be/pn249y7NFHY>

Create Play Schedule

<https://mathshelf.com/dashboard/schedule>